

| SYMBOL DEFINITION  |                                  |   |
|--|----------------------------------|---|
| A DIMENSION WITHOUT AN INSPECTION REPORT SYMBOL ( ) DOES NOT REQUIRE INSPECTION. IT MAY BE CONTROLLED ON THE INDIVIDUAL COMPONENT DRAWING. | TOTAL NO OF INSPECTIONS REQUIRED | 3 |
|  | LAST NO. USED                    | 3 |

| MISSING SYMBOLS |     |     |     |     | DWG STATUS |  | REVISION HISTORY |                      | AUTH   | DR  | APVD 1 | APVD 2 |
|-----------------|-----|-----|-----|-----|------------|--|------------------|----------------------|--------|-----|--------|--------|
| DATE            | STG | REV | N/P | CHG | ZONE       |  |                  |                      |        |     |        |        |
| 200C22          | R   | 01  | -   | -   |            |  |                  | CREATED PART DRAWING | 448451 | LI  | AM     | LI     |
| 28FE23          | R   | 02  | -   | -   |            |  |                  | ADDED PN 35748431    | 450187 | KZC | ZY     | LDD    |

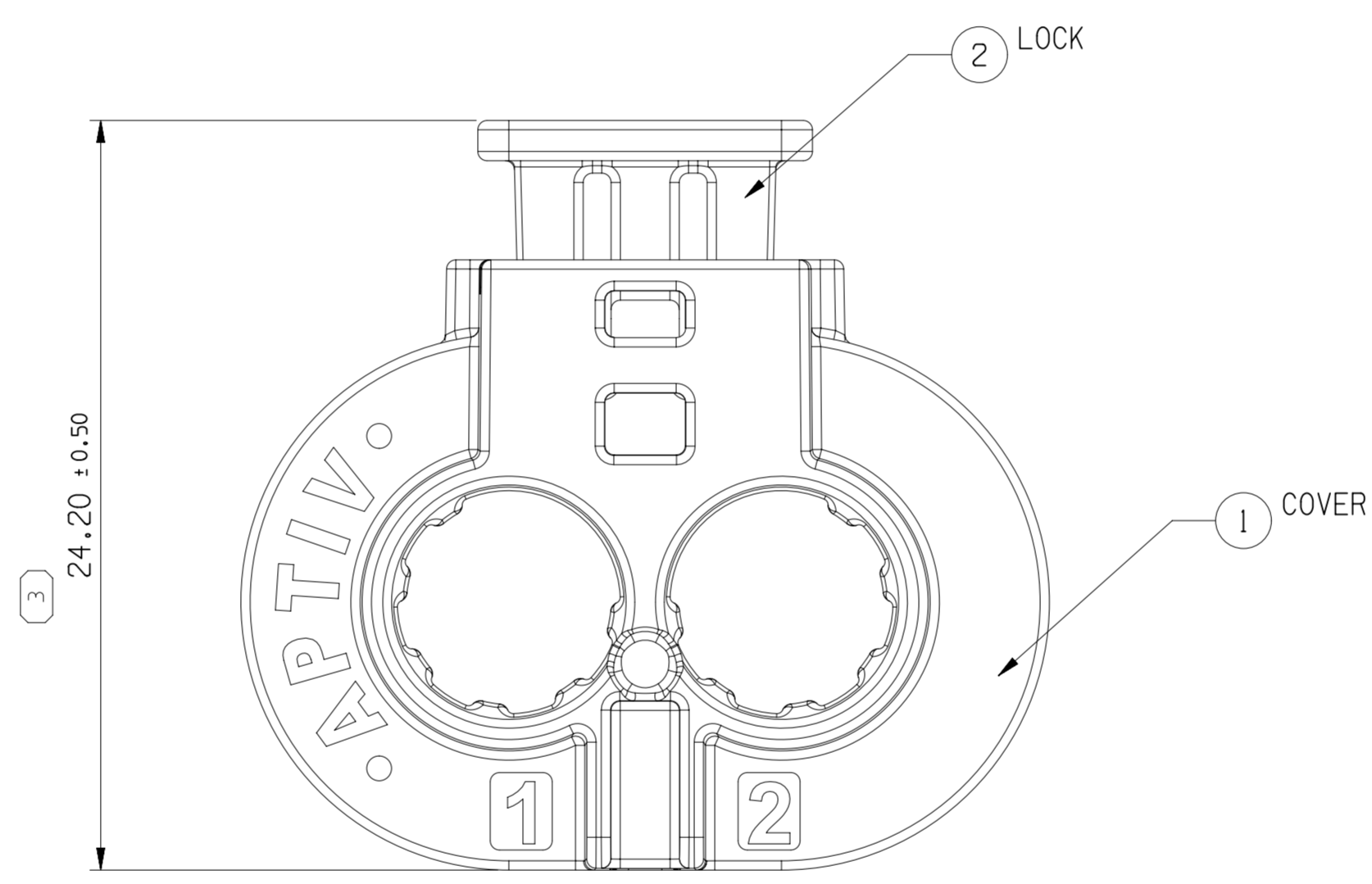
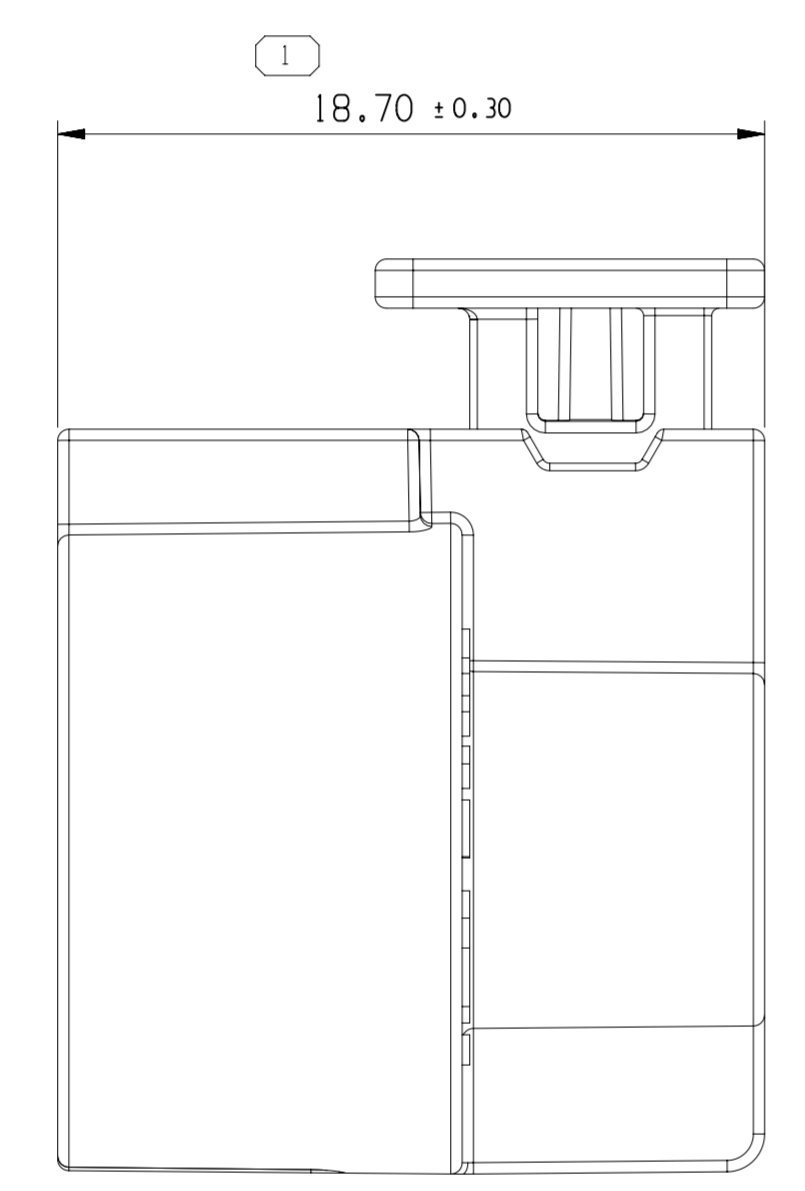
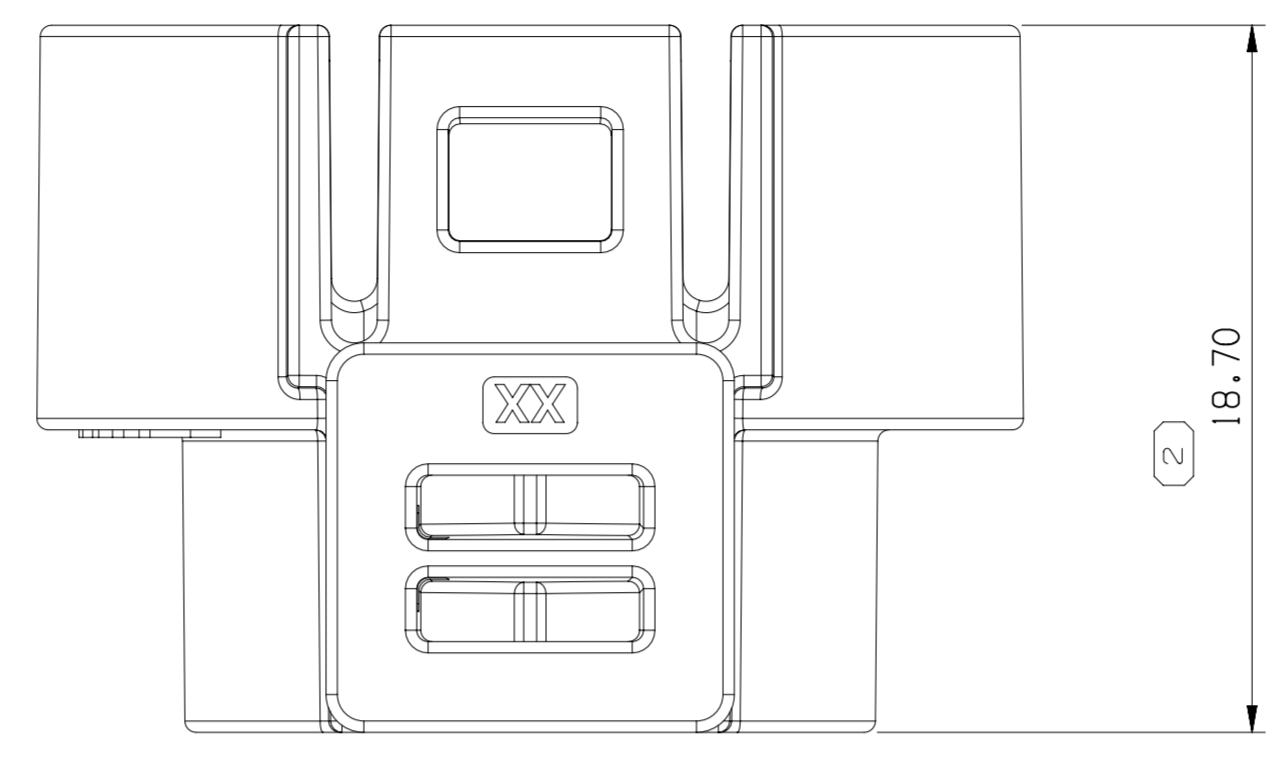
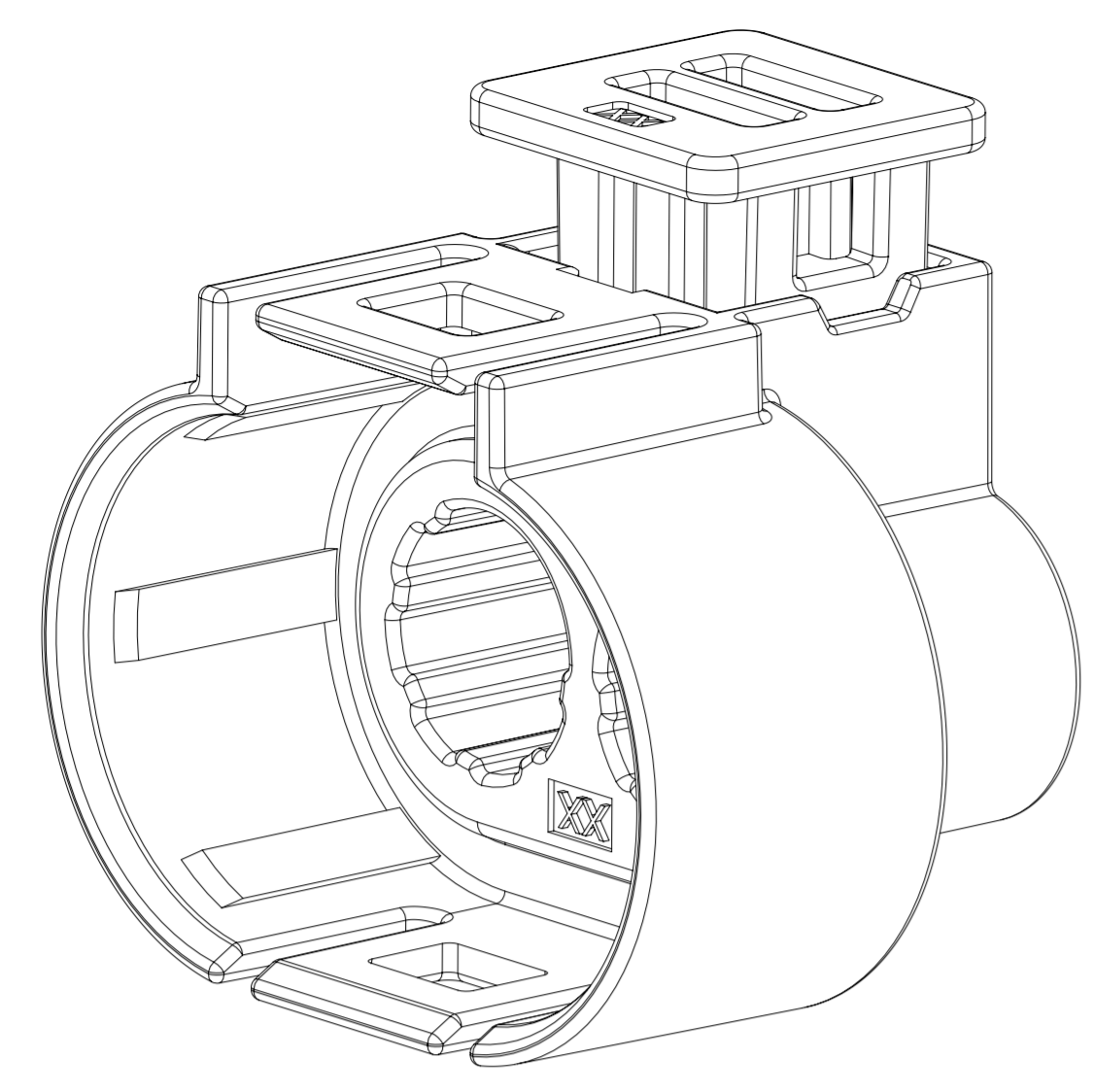

NOTES

- UNLESS OTHERWISE SPECIFIED AND/OR INDICATED:  
DIMENSIONS ARE TO FACE OF VIEW SHOWN AND AUTOMATICALLY ROUNDED BY COMPUTER FOR INSPECTION (SEE MATH MODEL FOR PRECISE DIMENSIONS). FOR ALL OTHER DIMENSIONS NOT SHOWN BUT REQUIRED FOR TOOL BUILD, SEE MATH MODEL FOR PRECISE TOOL PATH DATA.

A LINE DRAWN THROUGH A PART NUMBER INDICATES THAT PHYSICAL PARTS ARE NOT AVAILABLE FOR ORDERING.  
PART NUMBERS THAT DO NOT HAVE A LINE PRESENT INDICATE THAT PHYSICAL PARTS ARE AVAILABLE FOR ORDERING.  
CONTACT APTIV SALES TO ASSURE AVAILABILITY OF PARTS.

DWG TYPE: PART DRAWING

STYLE: SEE CHART

VOLUME (CM<sup>3</sup>): DISTR CODE: D

UNLESS OTHERWISE SPECIFIED  
THIS DOCUMENT IS IN ACCORDANCE WITH ASME Y14.5M-1994 AS AMENDED BY THE GM GLOBAL DIMENSIONING AND TOLERANCING ADDENDUM-2001. SEPARATE PATTERNS OF FEATURES MAY BE GAGED SEPARATELY REGARDLESS OF DATUM REFERENCES.

ALL DIMENSIONS ARE IN MILLIMETERS

THIRD ANGLE PROJECTION

DO NOT SCALE USE MATH DATA

NX

**• APTIV •**  
CONNECTION SYSTEMS  
Chennai, India  
COPYRIGHT 2022 APTIV. ALL RIGHTS RESERVED.

THIS DRAWING IS THE PROPERTY OF APTIV AND CONTAINS APTIV CONFIDENTIAL INFORMATION. THE REPRODUCTION, DISTRIBUTION AND UTILIZATION OF THIS DOCUMENT OR ITS RELATED CAD MATH DATA, AS WELL AS COMMUNICATION OF ANY CONTENT TO OTHERS, WITHOUT EXPRESS AUTHORIZATION, IS PROHIBITED.

|                 |        |
|-----------------|--------|
| DR              | DATE   |
| APVD1 LI BAO    | 200C22 |
| APVD2 ARTHUR MA | 200C22 |
| APVD3 LI BAO    | 200C22 |
| APVD4           |        |
| APVD5           |        |

SUBSTANCES OF CONCERN AND RECYCLED CONTENT 10949001 10949001

MATERIAL: POLYAMIDE BLEND

DRAWING NAME: TAXI COV STRAIN RLF

DRAWING NUMBER: 35657574

|      |       |          |          |     |     |     |
|------|-------|----------|----------|-----|-----|-----|
| SIZE | SCALE | FRAME NO | SHEET NO | STG | REV | N/P |
| A1   | 5#1   | 1 OF 1   | 1 OF 1   | R   | 02  | -   |

| NO. | PART NO. | TITLE                            | 1X COVER | 1X LOCK  | COLOR         |
|-----|----------|----------------------------------|----------|----------|---------------|
| 3   | 35748431 | ASM COVER FOR 2.5mm <sup>2</sup> | 35748432 | 35657043 | BLACK+RED     |
| 2   | 35657573 | ASM COVER FOR 4mm <sup>2</sup>   | 35657036 | 35657043 | BLACK+RED     |
| 1   | 35657572 | ASM COVER FOR 6mm <sup>2</sup>   | 35657036 | 35657041 | BLACK+NATURAL |

| DIMENSIONAL RANGE (MM) |       | CHART |       |
|------------------------|-------|-------|-------|
| FROM                   | TO    | M     | M     |
| > 0                    | > 6   | > 30  | > 70  |
| > 6                    | > 30  | > 70  | > 120 |
| > 30                   | > 70  | > 120 | > 160 |
| > 70                   | > 120 | > 160 | > 200 |
| > 120                  | > 160 | > 200 | > 250 |
| > 160                  | > 200 | > 250 | > 315 |
| > 200                  | > 250 | > 315 | > 400 |

TOLERANCE UNLESS OTHERWISE SPECIFIED

|      |      |      |      |       |       |      |       |       |
|------|------|------|------|-------|-------|------|-------|-------|
| ±0.1 | ±0.2 | ±0.3 | ±0.4 | ±0.45 | ±0.55 | ±0.7 | ±0.85 | ±1.05 |
|------|------|------|------|-------|-------|------|-------|-------|

ANGULAR TOLERANCE ±1°