

SYMBOL DEFINITION		
A DIMENSION WITHOUT AN INSPECTION REPORT SYMBOL DOES NOT REQUIRE INSPECTION. IT MAY BE CONTROLLED ON THE INDIVIDUAL COMPONENT DRAWING.	TOTAL NO OF INSPECTIONS REQUIRED	65
	LAST NO. USED	45

MISSING SYMBOLS		JWG STATUS			ZONE	REVISION HISTORY	AUTH	DR	APV1	APV2		
DATE	STG	REV	N/P	CHG								
2-4 7-10 13-17 20-25 29-30	25AU99	R	03	-	-	CLEARED REVISION COLUMN ALL PARTS REVISED LOCK AND SHROUD COVER	196586	DRR	DRR	SAN	M	
	19OC99	R	04	-	-	ALL PARTS - REVISED GRAPHICS	196725	LMM	RMM	SAN		
	28AP00	R	05	-	-	ALL PARTS - UPDATED PDM ATTRIBUTES	199535	CRW	MVA	MC		
	21DE00	R	06	-	-	ALL PARTS - 29.03 00.5 WAS 29.03 & PSD WAS 33	199491	GGI	GGI	SAN	L	
	26JN03	R	07	-	-	ALL PARTS- REVISED CHART TO SHOW MATING SEAL & TPA P/Ns; REVISED MATING COMPONENT NOTES; ADDED CPA P/N; MATERIAL SPEC. WAS R0100223	242960	ADK	ADK	SAN		
	01JL05	R	08	-	-	13534968 - RELEASED	269962	LMB	LMB	BR		
	28SE05	R	09	-	-	ALL PARTS - CHANGED "TYPE" FROM 118 TO 208 IN TAXI; UPDATED VOLUME IN CHART; 13540546 - RELEASED	271854	LMB	LMB	BR		
	09MR06	R	10	-	-	ALL PARTS - TERMINAL 15304720 WAS 15304718, CABLE SEAL 15366067 WAS 12191232; 13540546 - REVISED DELPHI LOGO AND TYPE 214 VIEW LABEL	277561	MAC	MAC	SAN		
	26AP06	R	11	-	-	13540546 - 29.77 +0.37/-0.2 WAS 29.77	279991	JPH	FKV	RWR		
	17MY06	R	12	-	-	ALL PARTS - UPDATED PDM ATTRIBUTES; 15326650, 15326916 - RESTRICTED AND ADDED REPLACED BY COLUMN	280598	CCV	JVM	RWR		
	20FE08	R	13	-	-	ALL PARTS - ADDED COL TO CHART FOR "RECOMMENDED USAGE", APPLICATION DATA NOTE, APPEARANCE ITEM NOTE & RECYCLING CODE LABEL, REMOVED COL FROM CHART FOR "REPLACED BY", PART ACCEPTS NOTE, REFERENCE MATING NOTE, USED IN ASSEMBLIES NOTE, MATING CONN COL, MATING PLR COL, MATING CONN SEAL COL & MATING TPA COL AND REVISED MAT'L CALLOUT TO GENERIC CALLOUT; 15326650 & 15326916 - REMOVED RESTRICTED STATUS; 13672061, 13658979 & 13672059 - RELEASED; 15326650 & 15326916 - ADDED NOTE FOR RECOMMENDED USAGE	402837	JTV	AUG	RWR		
	18JL13	R	14	-	-	13658979 - UPDATED PART AVAILABILITY	423286	CAR	JVM	JSM		K
	07FE19	R	15	-	-	13534968 - UPDATED PDM ATTRIBUTES	442332	J60	JAA	VHG		

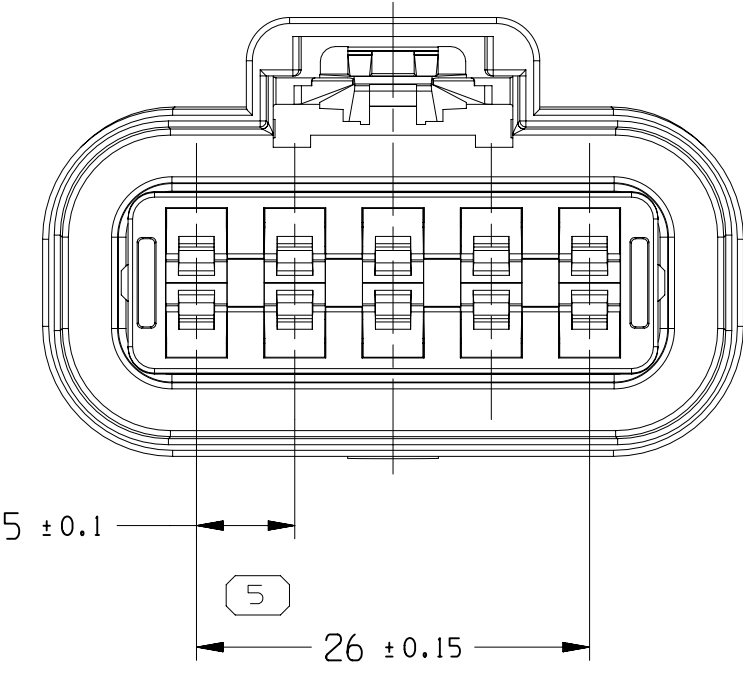

TYPE 110
SAME AS TYPE 108
EXCEPT AS SHOWN

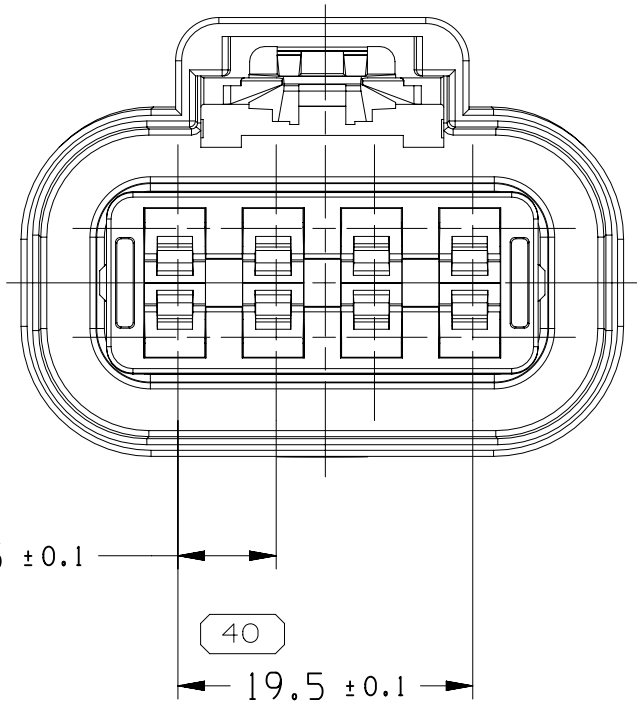

TYPE 110
SAME AS TYPE 108
EXCEPT AS SHOWN

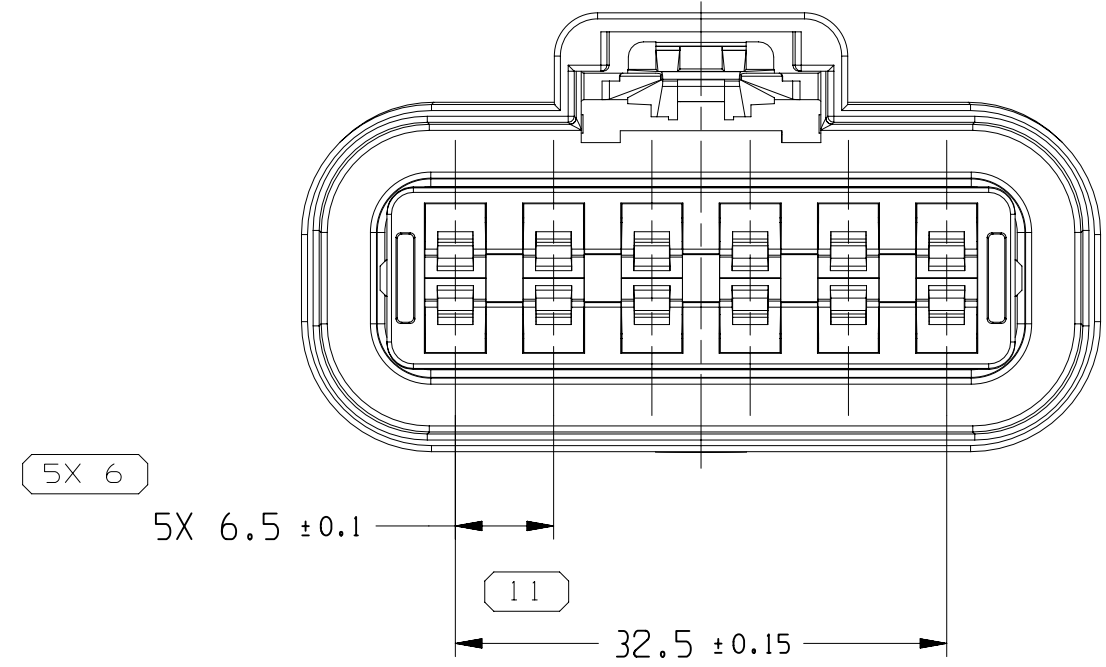
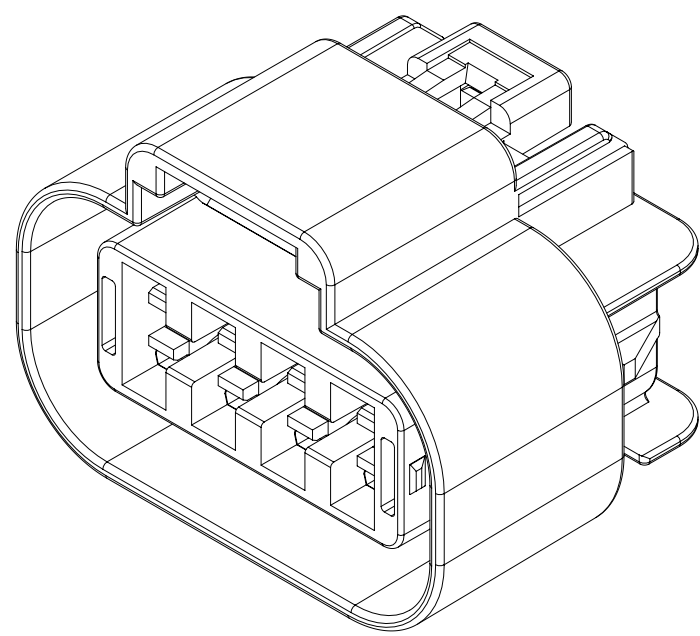
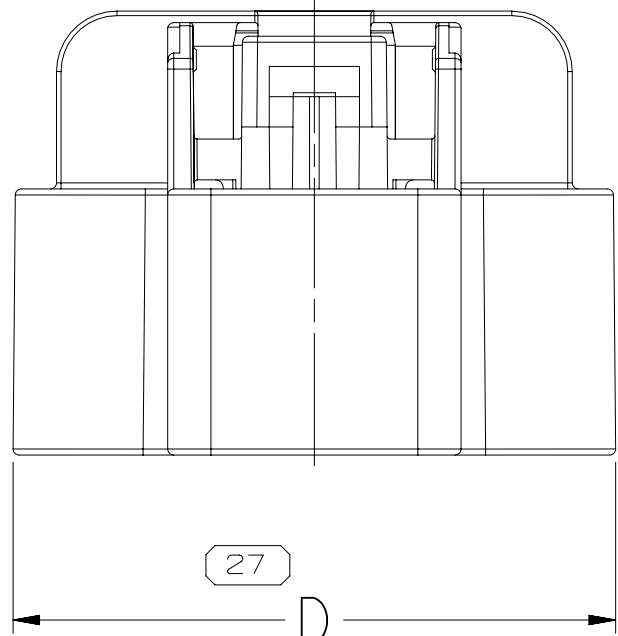
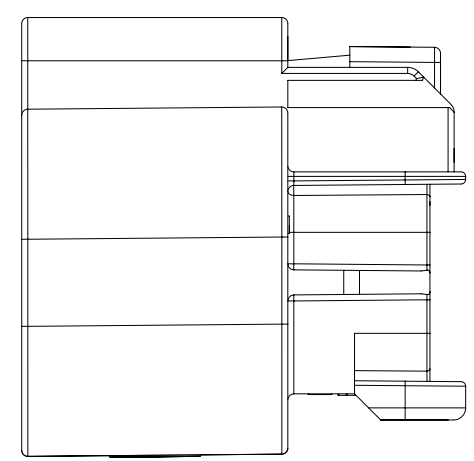

TYPE 112
SAME AS TYPE 108
EXCEPT AS SHOWN

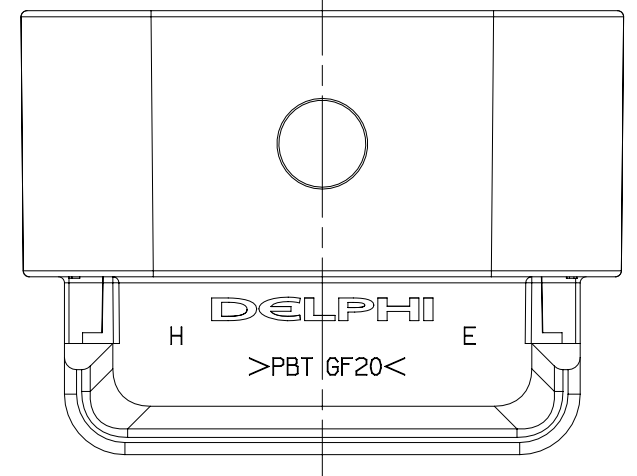

TYPE 208
SAME AS TYPE 108
EXCEPT AS SHOWN

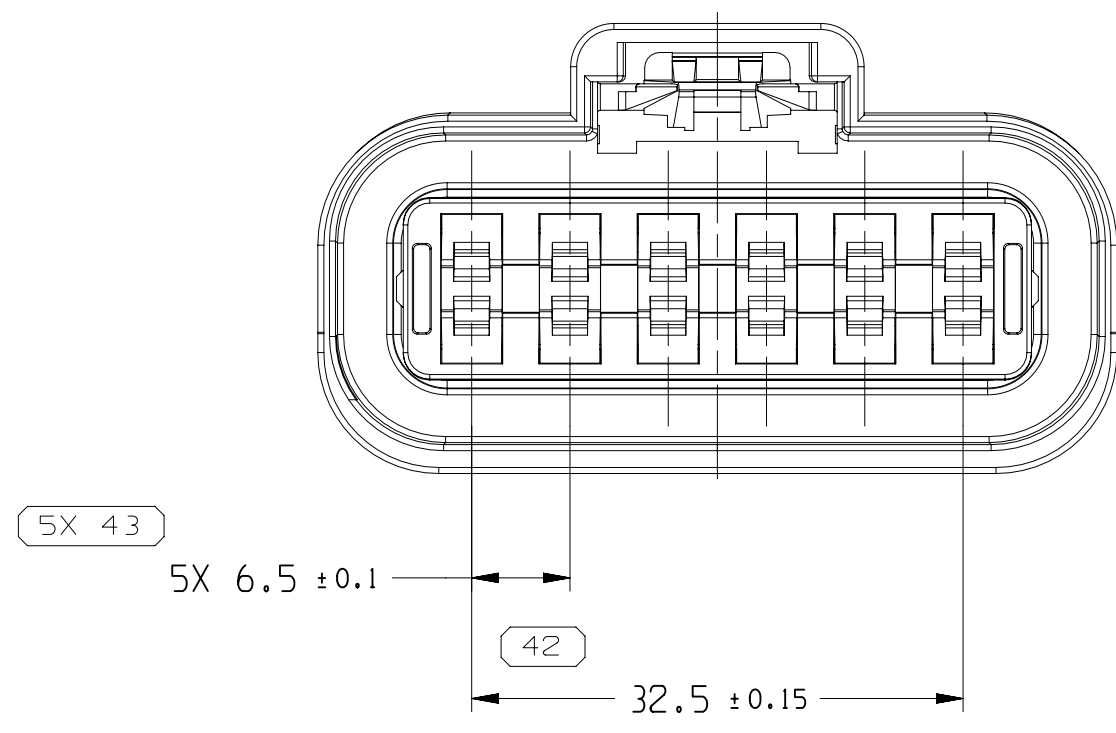

TYPE 212
SAME AS TYPE 214
EXCEPT AS SHOWN

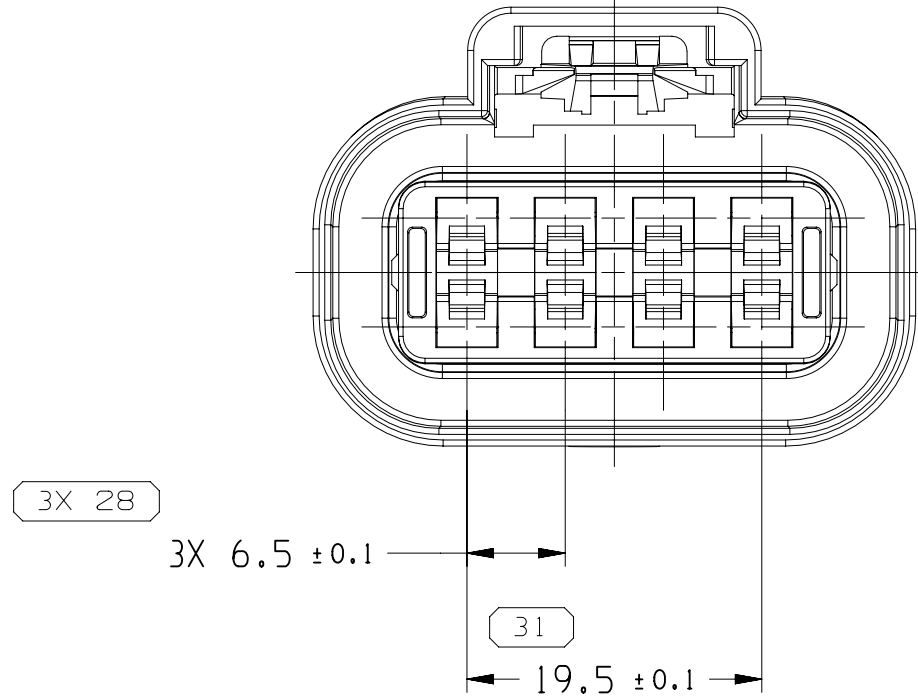

TYPE 108

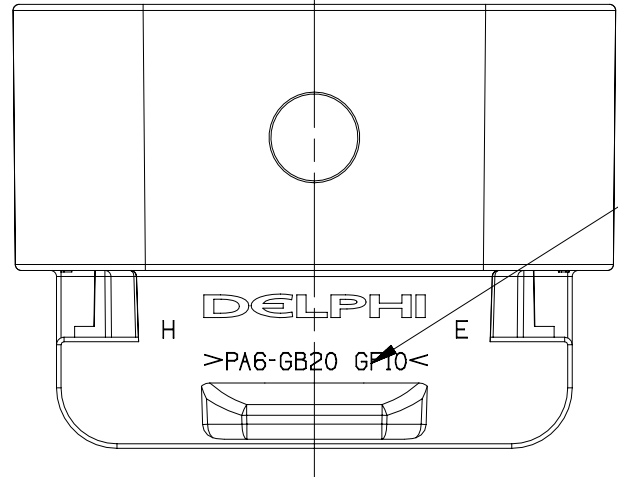

MAT'L RECYCLING CODE OPTIONAL

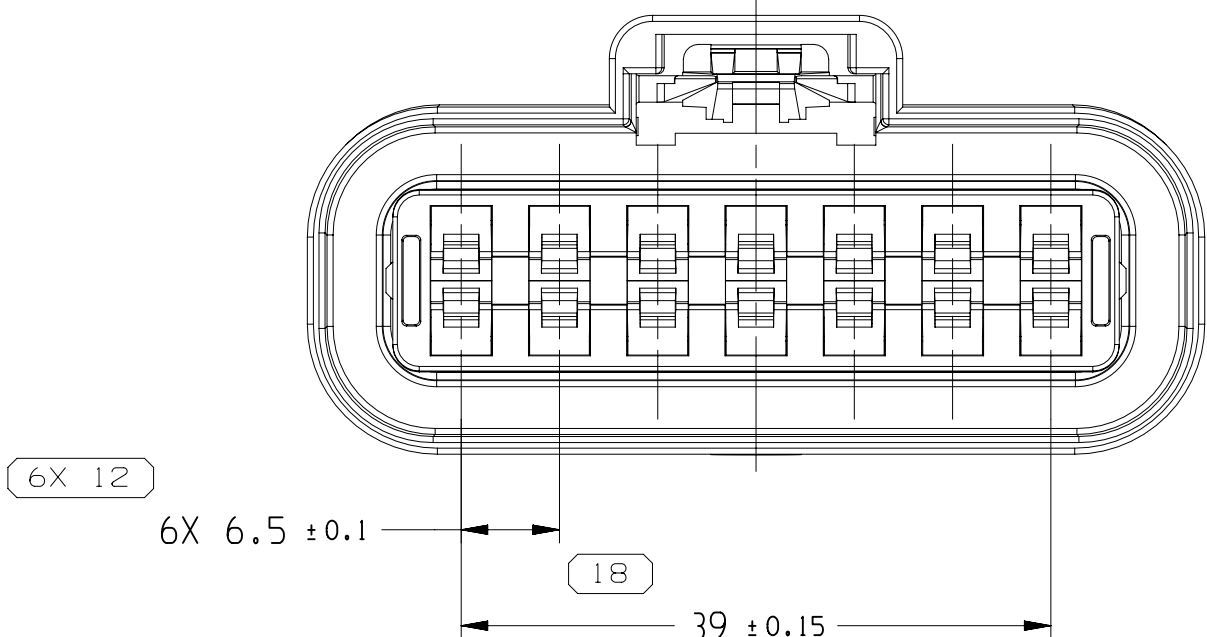

TYPE 114
SAME AS TYPE 108
EXCEPT AS SHOWN

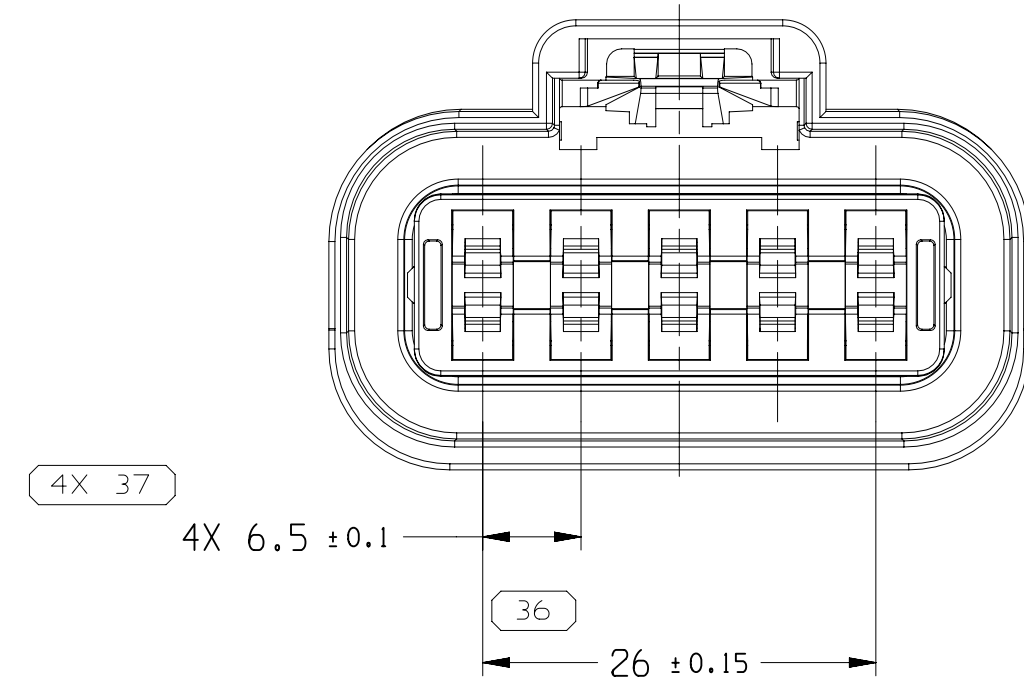

TYPE 210
SAME AS TYPE 214
EXCEPT AS SHOWN

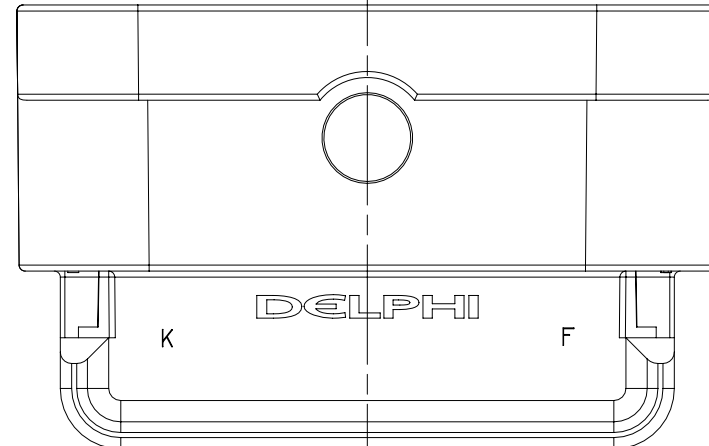

TYPE 116
SAME AS TYPE 108
EXCEPT AS SHOWN

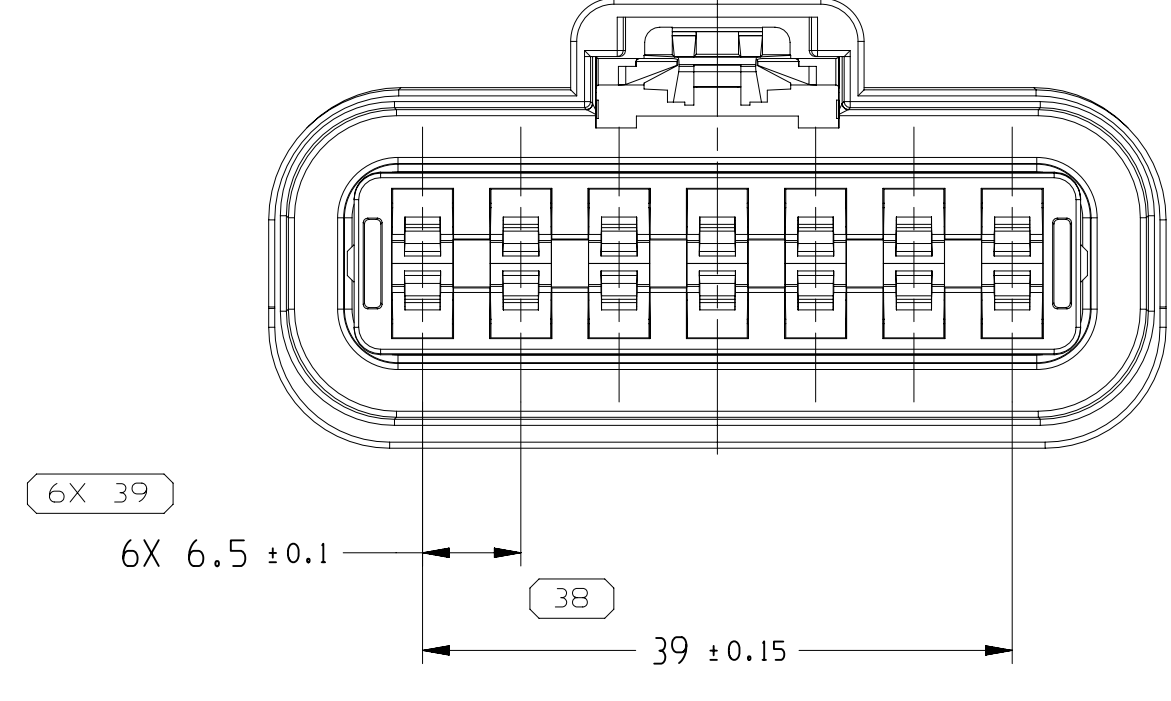
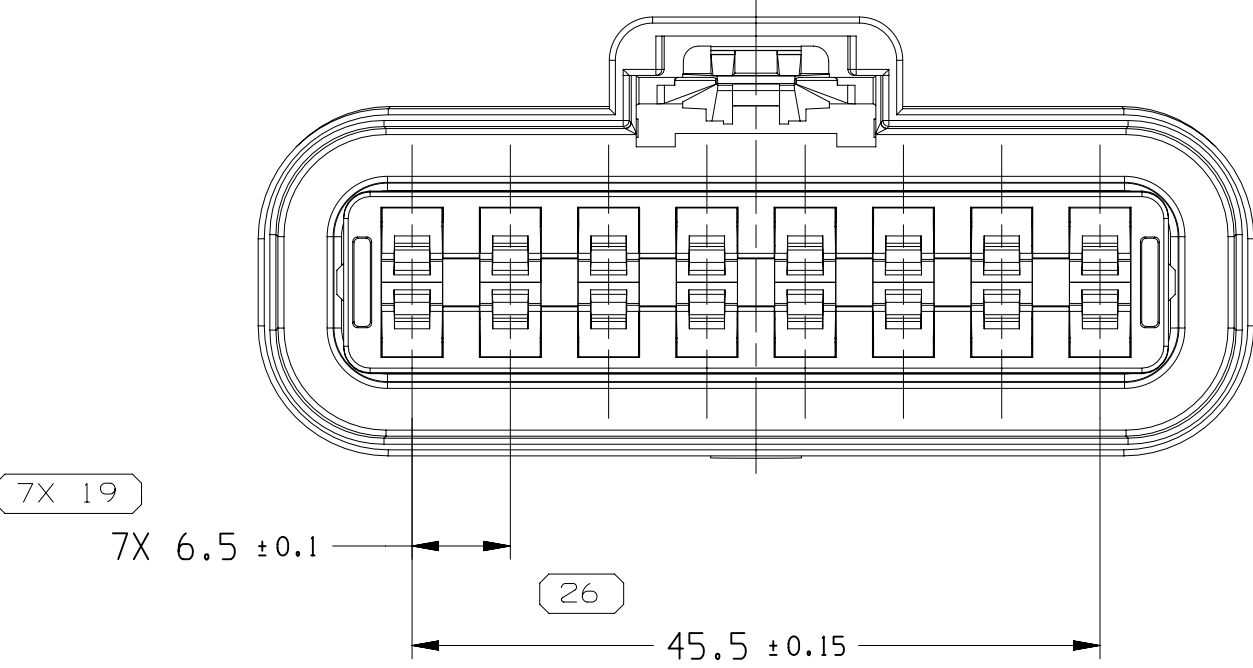

TYPE 214
SAME AS TYPE 114
EXCEPT AS SHOWN

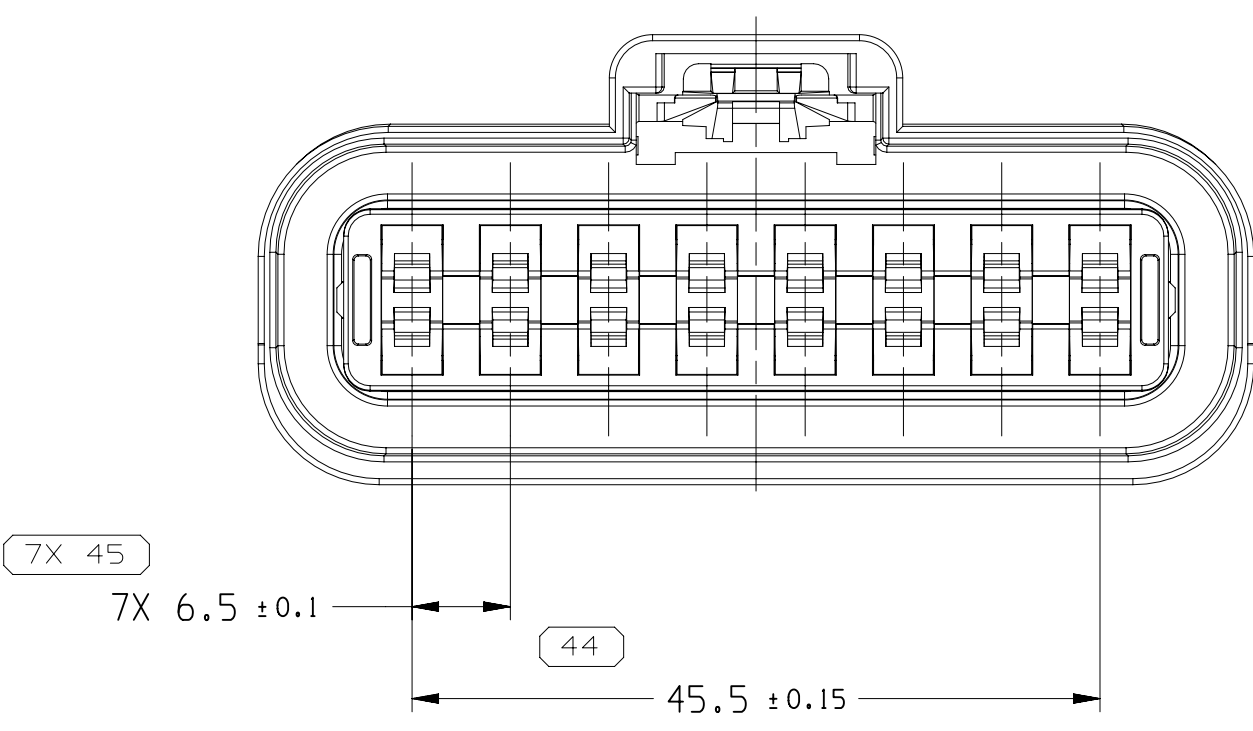
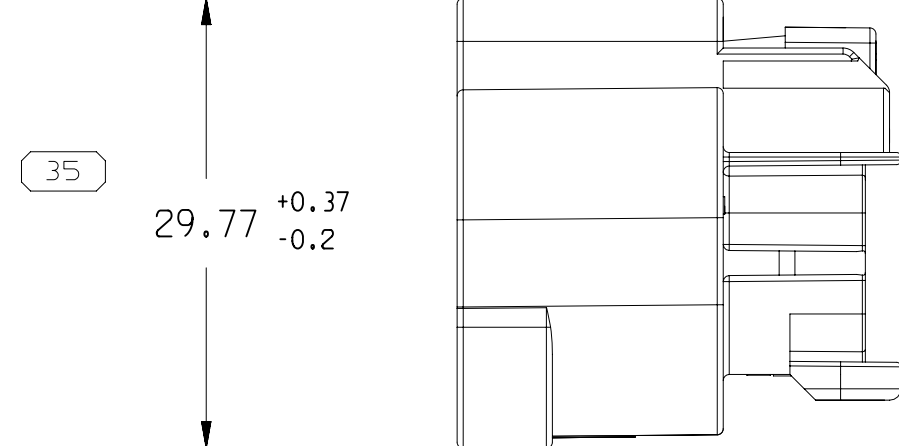

TYPE 216
SAME AS TYPE 214
EXCEPT AS SHOWN

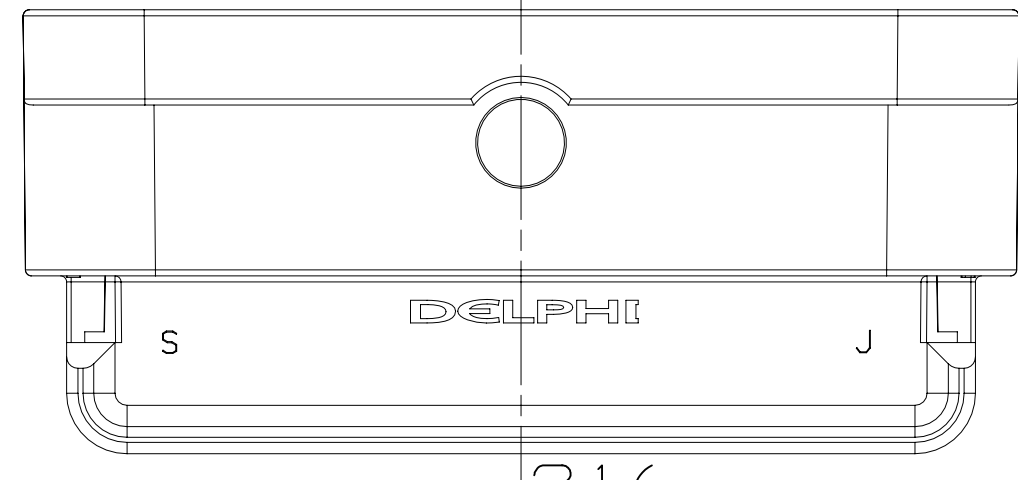

PART NO	PART NO	REV	N/P	RECOMMENDED USAGE	TYPE	MATERIAL SPECIFICATION AND COLOR	D	VOLUME
13672061	-	01	-	-	212	POLYESTER COMPOUND BLACK	52.85	12.050
13658979	-	01	AA	-	216	POLYESTER COMPOUND BLACK	65.85	14.971
13672059	-	01	-	-	210	POLYESTER COMPOUND BLACK	46.35	10.625
13540546	-	01	AD	-	214	POLYESTER COMPOUND BLACK	59.35	13.529
13534968	-	02	AD	-	208	POLYESTER COMPOUND BLACK	39.85	8.912
15326916	ID406345	03	AJ	DO NOT PROLIFERATE REPLACED BY 13540546	114	POLYAMIDE COMPOUND BLACK	59.35	13.033
15326909	ID406339	03	AJ	-	112	POLYAMIDE COMPOUND BLACK	52.85	11.603
15326662	ID406350	03	AJ	-	116	POLYAMIDE COMPOUND BLACK	65.85	14.416
15326656	ID406328	03	AJ	-	110	POLYAMIDE COMPOUND BLACK	46.35	10.235
15326650	ID406317	03	AJ	DO NOT PROLIFERATE REPLACED BY 13534968	108	POLYAMIDE COMPOUND BLACK	39.85	8.794

NOTES

- UNLESS OTHERWISE SPECIFIED AND/OR INDICATED:

DIMENSIONS ARE TO FACE OF VIEW SHOWN AND AUTOMATICALLY ROUNDED BY COMPUTER FOR INSPECTION. (SEE MATH MODEL FOR PRECISE DIMENSIONS.) FOR ALL OTHER DIMENSIONS NOT SHOWN BUT REQUIRED FOR TOOL BUILD, SEE MATH MODEL FOR PRECISE TOOL PATH DATA.

- MATERIAL RECYCLING CODE PER ISO 11469. (11.51X10.05) RAISED CHARACTERS AS SHOWN TO BE LOCATED ON ANY EXTERIOR SURFACE, OPTIONALLY CONSTRUCTION TO BE NO MATERIAL RECYCLING CODE.

- (11.51X10.05) RAISED DELPHI CORPORATE BRAND TO BE LOCATED ON ANY EXTERIOR SURFACE, PREFERABLY VISIBLE AT FINAL ASSEMBLY. OPTIONAL CONSTRUCTION TO BE "PED" OR NO LOGO.

- THIS PRODUCT IS NOT CATEGORIZED AS AN APPEARANCE ITEM, MINOR IMPERFECTIONS INCLUDING, BUT NOT LIMITED TO, FLOW MARKS, COLOR BLENDING, GATE VESTIGE, AND SOFT FLASH THAT DO NOT AFFECT THE FIT, FORM, OR FUNCTION OF THE PART ARE PERMISSIBLE PER NAP 4.10-18.

- FOR APPLICATION DATA SEE THE INDIVIDUAL APPLICATION DRAWINGS.

DIMENSIONAL RANGE (MM)		CHART	
FROM	TO	FROM	TO
0	20	0	20
20	30	30	40
30	40	40	50
40	50	50	60
50	60	60	70
60	70	70	80
70	80	80	90
80	90	90	100
90	100	100	110
100	110	110	120
110	120	120	130
120	130	130	140
130	140	140	150
140	150	150	160
150	160	160	170
160	170	170	180
170	180	180	190
180	190	190	200
190	200	200	210
200	210	210	220
210	220	220	230
220	230	230	240
230	240	240	250
240	250	250	260
250	260	260	270
260	270	270	280
270	280	280	290
280	290	290	300
290	300	300	310
300	310	310	320
310	320	320	330
320	330	330	340
330	340	340	350
340	350	350	360
350	360	360	370
360	370	370	380
370	380	380	390
380	390	390	400
390	400	400	410
400	410	410	420
410	420	420	430
420	430	430	440
430	440	440	450
440	450	450	460
450	460	460	470
460	470	470	480
470	480	480	490
480	490	490	500
490	500	500	510
500	510	510	520
510	520	520	530
520	530	530	540
530	540	540	550
540	550	550	560
550	560	560	570
560	570	570	580
570	580	580	590
580	590	590	600
590	600	600	610
600	610	610	620
610	620	620	630
620	630	630	640
630	640	640	650
640	650	650	660
650	660	660	670
660	670	670	680
670	680	680	690
680	690	690	700
690	700	700	710
700	710	710	720
710	720	720	730
720	730	730	740
730	740	740	750
740	750	750	760
750	760	760	770
760	770	770	780
770	780	780	790
780	790	790	800
790	800	800	810
800	810	810	820
810	820	820	830
820	830	830	840
830	840	840	850
840	850	850	860
850	860	860	870
860	870	870	880
870	880	880	890
880	890	890	900
890	900	900	910
900	910	910	920
910	920	920	930
920	930	930	940
930	940	940	950
940	950	950	960
950	960	960	970
960	970	970	980
970	980	980	990
980	990	990	1000

THIRD ANGLE PROJECTION		DO NOT SCALE	
USE MATH DATA	USE MATH DATA	USE MATH DATA	USE MATH DATA

THIRD ANGLE PROJECTION		DO NOT SCALE	
USE MATH DATA	USE MATH DATA	USE MATH DATA	USE MATH DATA

PART DRAWING		DATE	
STYLE	SEE CHART	DATE	27FE97
VOLUME (CMT)	DISTR CODE	APV01	M. MCCALL
		APV02	M. MCCALL
		APV03	S.A. NORLING
		APV04	25AU97
		APV05	
THIS DOCUMENT IS IN ACCORDANCE WITH ASME Y14.5M-1994 AS MODIFIED BY THE GM GLOBAL DIMENSIONING AND TOLERANCING ADDENDUM-2003. SEPARATE PATTERNING OF FEATURES MAY BE ISSUED SEPARATELY REGARDLESS OF DATUM REFERENCES.		SUBSTANCES OF CONCERN AND RECYCLED CONTENT PER APTIV (1049200)	
ALL DIMENSIONS ARE IN MILLIMETERS		DRAWING NAME	
REFERENCE		TAXI CONN F GT 280 SLD	
		DRAWING NUMBER	
		15326668	
		SIZE	
		A0	
		SCALE	
		2:1	
		FRAME NO	
		1 OF 1	
		SHEET NO	
		1 OF 1	
		STG REV	
		R 15	