

TYPE 102
SAME AS TYPE 101
EXCEPT AS SHOWN

ADDITIONAL ASSEMBLY INFORMATION

CAVITIES 1 & 2

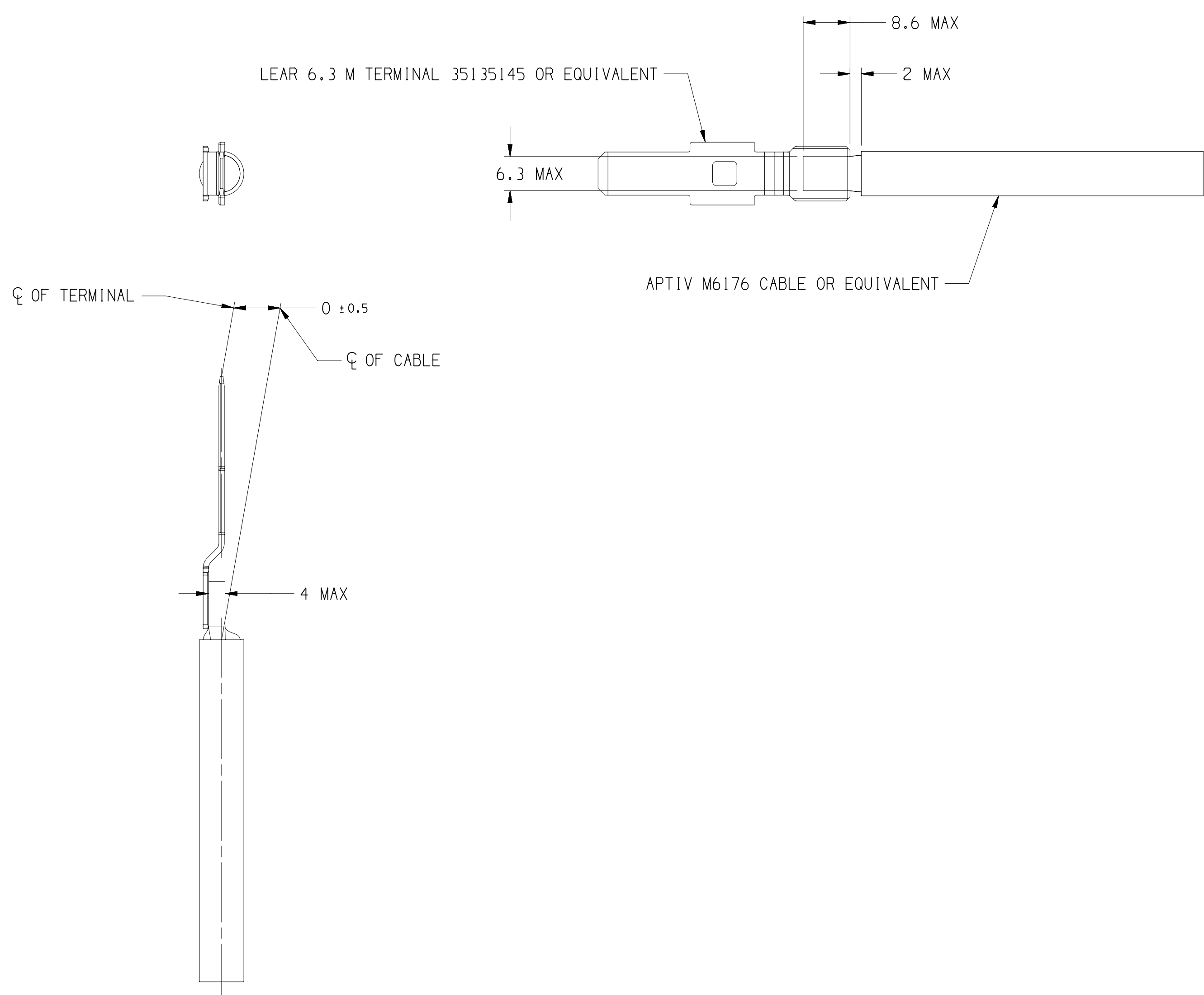

CAVITIES 3 & 4

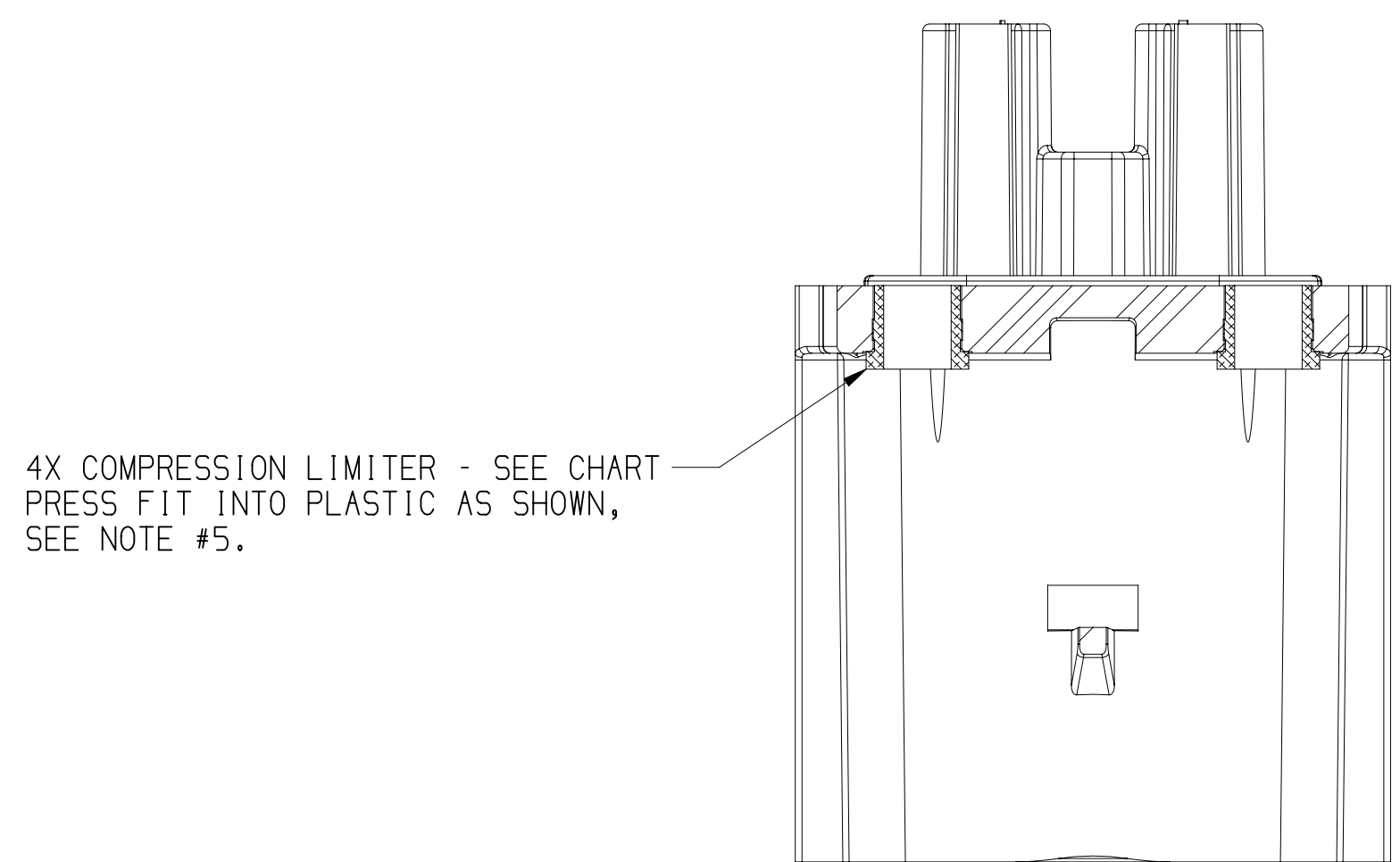
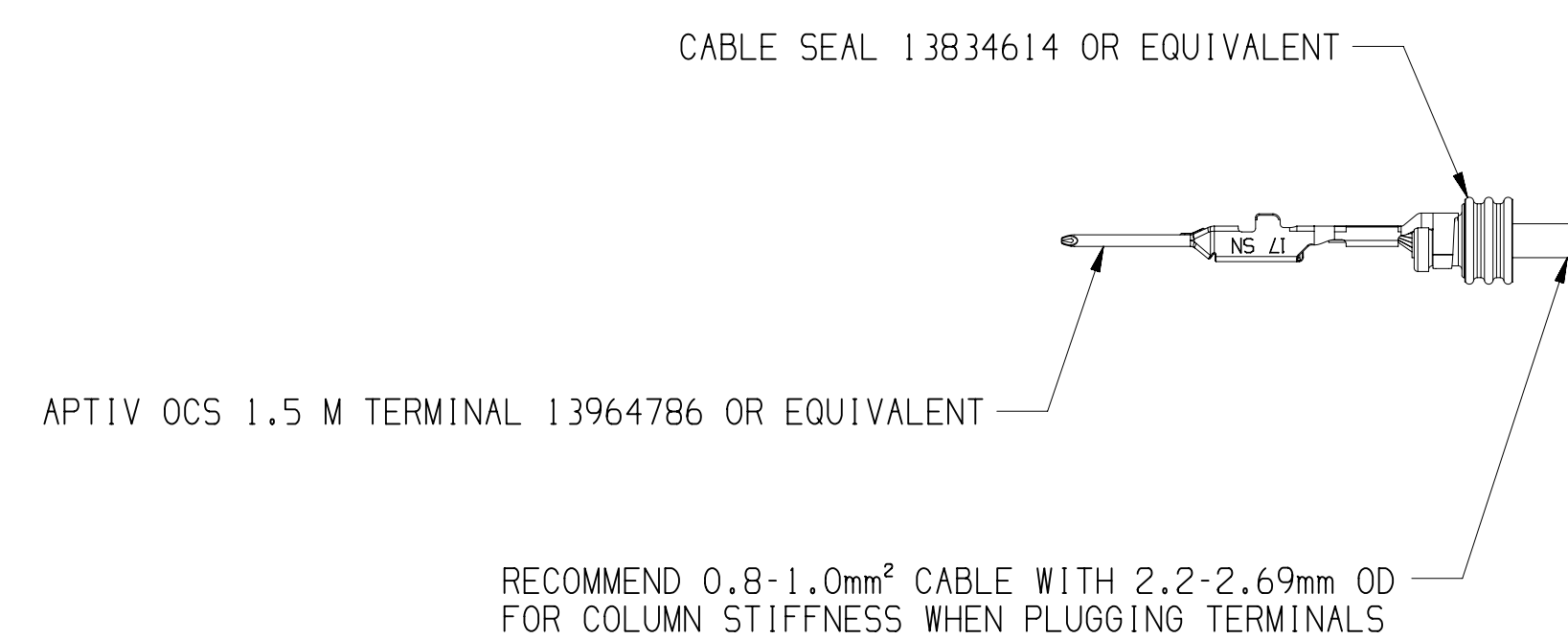

SECTION B-B

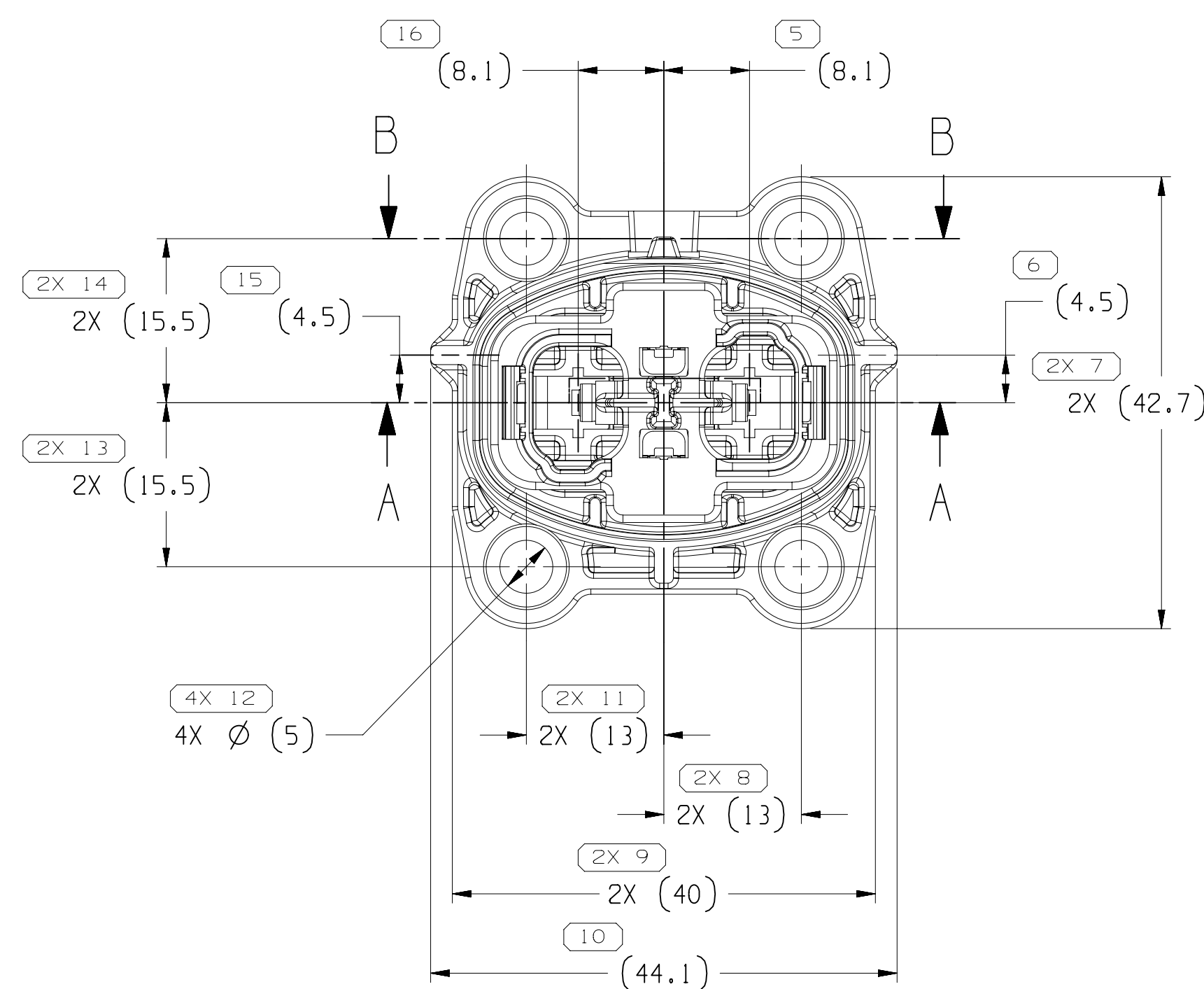
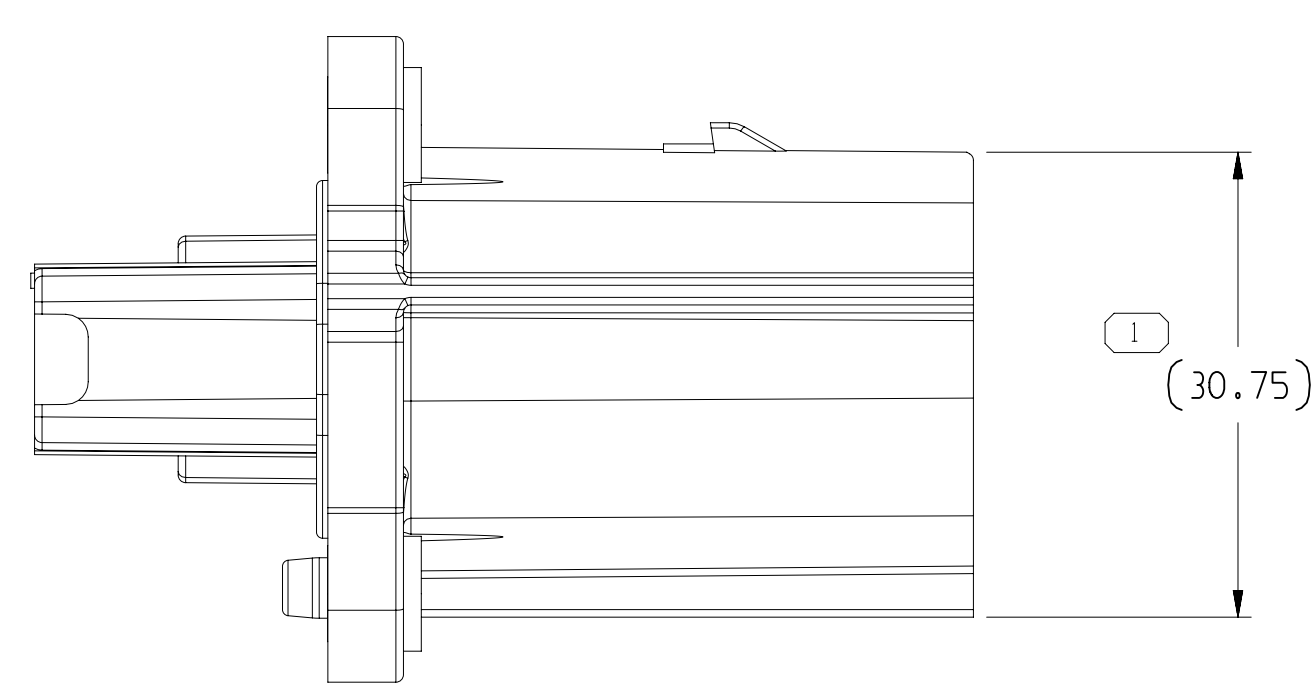
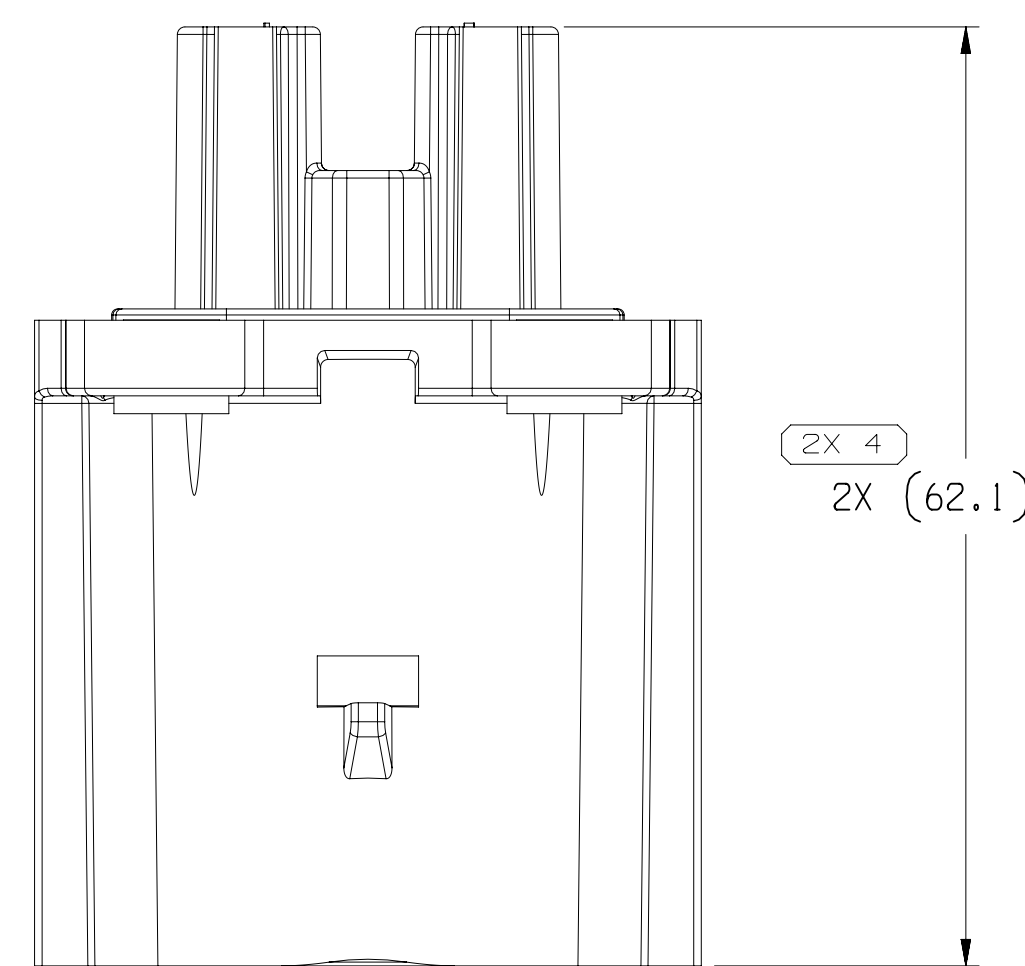

TYPE 101

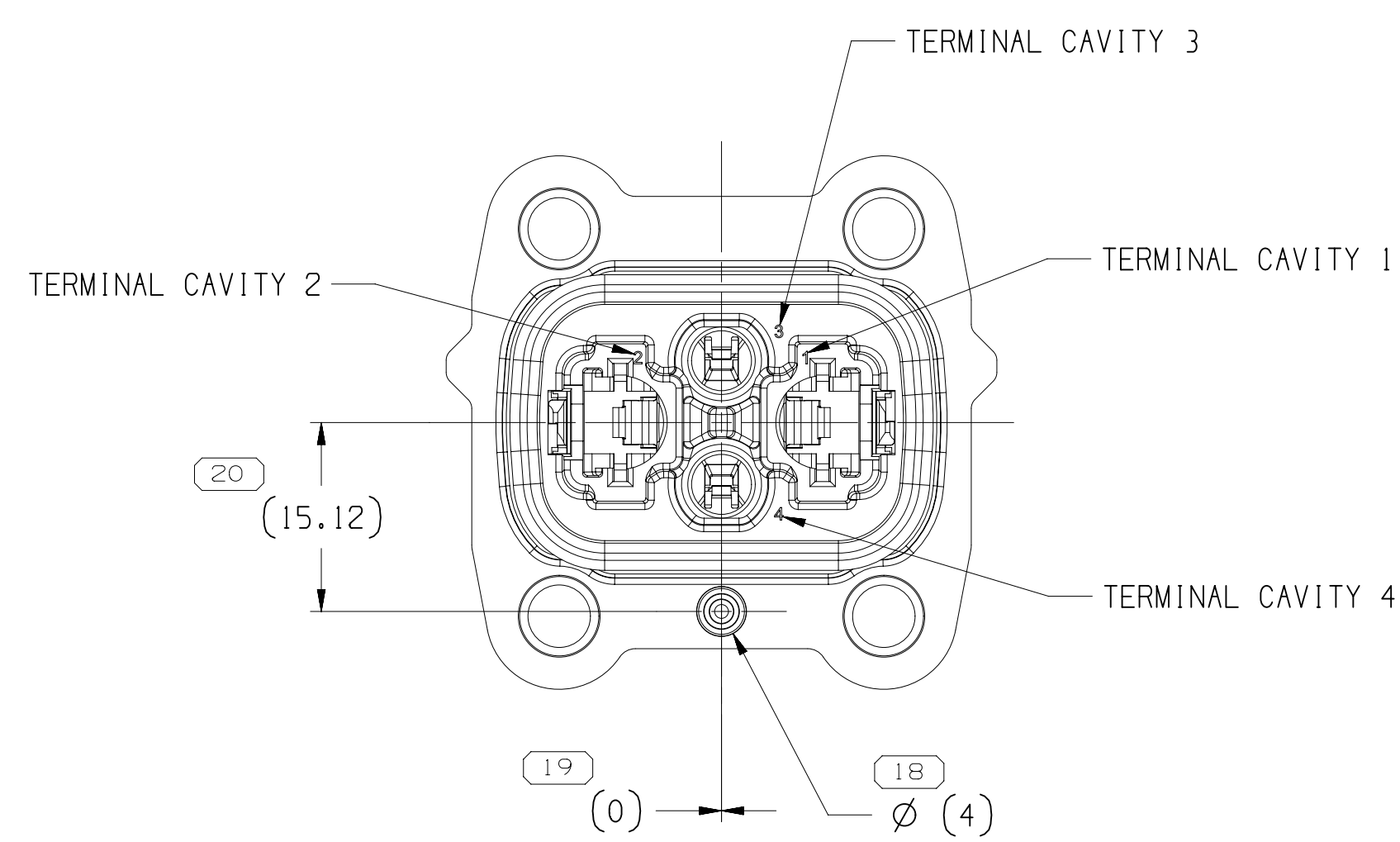
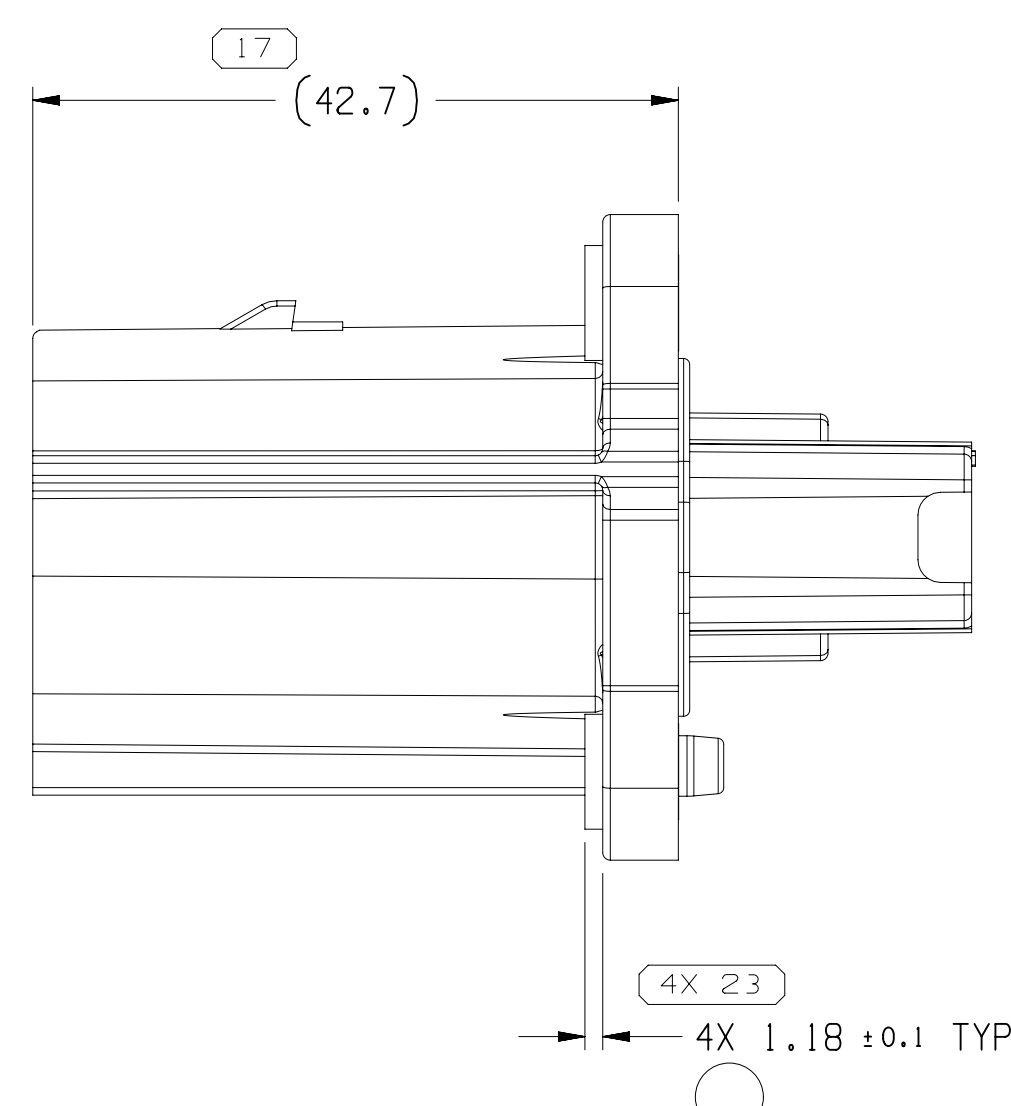

- NOTES
- UNLESS OTHERWISE SPECIFIED AND/OR INDICATED:
DIMENSIONS ARE TO FACE OF VIEW SHOWN AND AUTOMATICALLY ROUNDED BY COMPUTER FOR INSPECTION (SEE MATH MODEL FOR PRECISE DIMENSIONS). FOR ALL OTHER DIMENSIONS NOT SHOWN BUT REQUIRED FOR TOOL BUILD, SEE MATH MODEL FOR PRECISE TOOL PATH DATA.
 - REFERENCE MATING COMPONENTS OR EQUIVALENT:
CONNECTOR ASSEMBLIES SHOWN ON TAXI 35197133
 - FOR MATING CASE DETAIL SEE 13947505.
FOR CONNECTOR ASSEMBLY MANUAL SEE 35219215.
 - SEAL MAY BECOME DISLOOSED DURING SHIPPING AND HANDLING. BEFORE ATTACHING TO THE MATING DEVICE OR COVER, THE OPERATOR MUST ENSURE THE SEAL IS INTACT AND PROPERLY ASSEMBLED AS SHOWN.
 - M4 FASTENER HEAD OD NOT TO EXCEED 8MM. M4 HEAD HEIGHT NOT TO EXCEED 4MM.
M4 RECOMMENDED TIGHTENING TORQUE IS 2.5 N-M. DEVICE SUPPLIER IS RESPONSIBLE FOR SPECIFYING FINAL TORQUE IN SPECIFIC APPLICATIONS.
 - CONNECTOR ASSEMBLIES ARE VALIDATED TO SAE/USCAR-37 REV.01 - AUG.'08 TEMPERATURE CLASS T3, SEALING CLASS S3, VIBRATION CLASS V1, AND MATING CYCLES M1, ON APTIV M6176 CABLE WHICH MEETS REQUIREMENTS OF ISO 6722.
 - HARNESS MANUFACTURER IS RESPONSIBLE FOR VALIDATING THE CONNECTION AS APPLIED ON OTHER CABLE TO THE REQUIREMENTS OF SPECIFIC APPLICATIONS.
 - CONNECTOR DESIGNS PROVIDE THE FOLLOWING MINIMUM GREEPAGE DISTANCES WHEN MATED, AS ASSESSED PER IEC60664 WITH POLLUTION DEGREE : 2 OR 3:
-CAVITIES 1 TO 2 : 15mm
-CAVITIES 1 OR 2 TO 3 OR 4 : 7mm
 - THIS ASSEMBLY MUST BE LEAK TESTED PER ES-A-755.

35197120	01	AA	102	35197123	35197125	13895872	33211751
35197119	01	AA	101	35197122	35197125	13895872	33211751
PART NO	REV	N/P	TYPE	HEADER CONN	PLR	FACE SEAL	COMPRESSION LIMITER

DIMENSIONAL RANGE (MM)		CHART												
FROM	> 0	> 30	> 30	> 70	> 100	> 100	> 150	> 150	> 200	> 200	> 250	> 250	> 300	> 300
TO	20	30	70	100	150	200	250	300	400	500	600	700	800	900
TOLERANCE UNLESS OTHERWISE SPECIFIED														
		+0.15	+0.2	+0.3	+0.4	+0.5	+0.6	+0.8	+1	+1.5	+2	+3	+4	+5
ANGULAR TOLERANCE ±2°														

THIRD ANGLE PROJECTION	DO NOT SCALE	USE MATH DATA	NX
------------------------	--------------	---------------	----

• APTIV •	
CONNECTION SYSTEMS	
COPYRIGHT 2020 APTIV. ALL RIGHTS RESERVED.	
DR	DATE
APPROV1 CARLOS DELGADILLO	190C20
APPROV2 CARLOS DELGADILLO	190C20
APPROV3 EDUARDO RUIZ M.	190C20
APPROV4	
SUBSTANCES OF CONCERN AND RECYCLED CONTENT: 100% APTIV (10049000)	
REVISIONS: SEE CHART	
DRAWING NAME: TAXI ASM CONN 4 M/H/VOLTAGE MIXED SLD	
DRAWING NUMBER: 35197121	
SIZE: A1x3	SCALE: 2:1
FRAME NO: 1	SHEET NO: 1
STO: 1	REV: 02